



COPELE



KIT DESPLAZAMIENTO:
Cod.30968



Cod.30966 + Cod.30968

Seznam dílů:

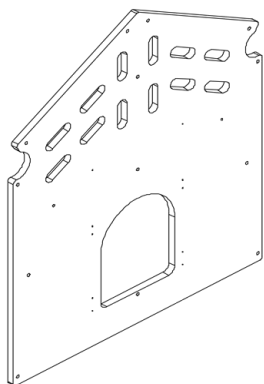

53096604
centrální přední část
1 kus

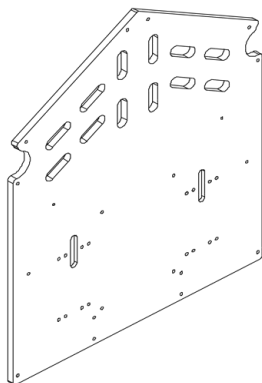

53096607
boční část
1 kus

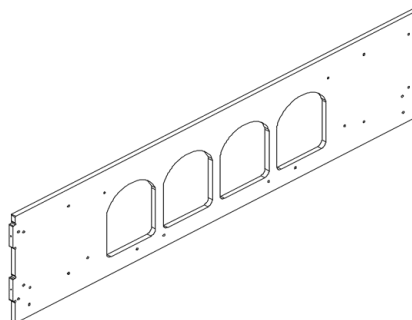

53096612
strana s otvory pro kukaně
1 kus

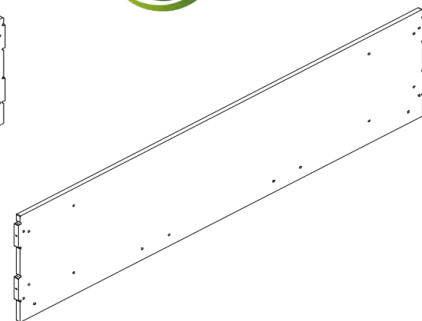

53096613
strana bez mezer
1 kus

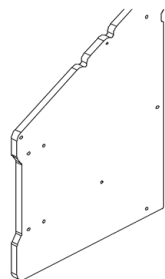

53096605
přední levá část
2 kusy

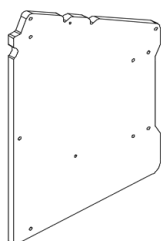

53096606
přední pravá část
2 kusy

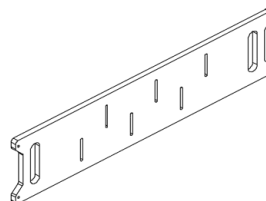

53096609
rampa (bidýlko)
1 kus

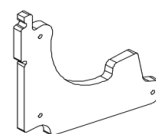

53096608
podpěra
2 kusy

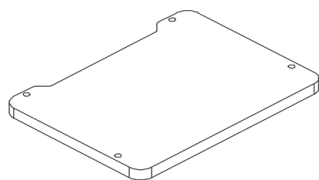

53096610
pracovní deska
1 kus

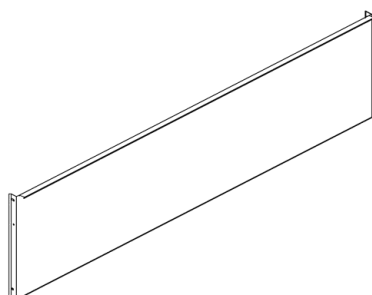

53096602
Sklopná střecha
2 kusy

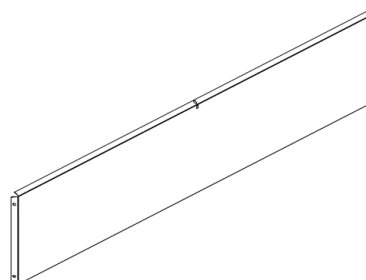

53096601
Techo fijo
2 Unds

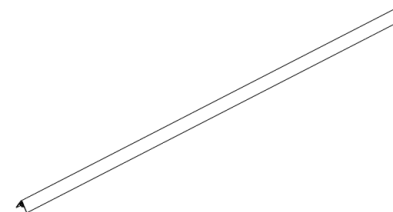

53096603
Profil pro upevnění podlahy
6 kusů

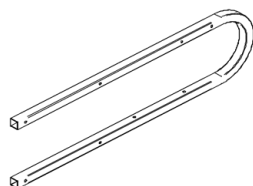

53096611
Zaoblená noha
3 kusy

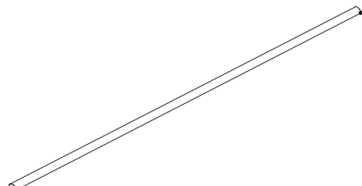

53096615
Pojezdová tyč L=1846
2 kusy

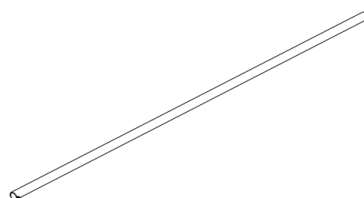

53096614
Pojezdová tyč L=1882
2 kusy

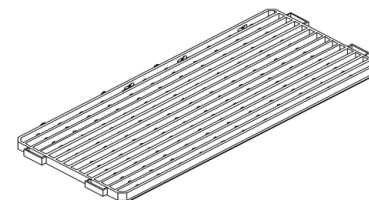

01078500
Plastová podlážka Duero
9 kusů

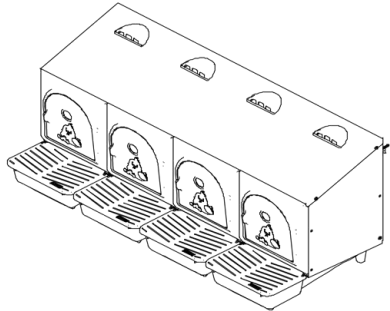

03093200
Kukaň pro slepice 4 místa
1 kus



53096617
Plastový barel 55l
1kus

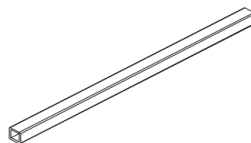

53096618
PVC trubka L=460
1 kus

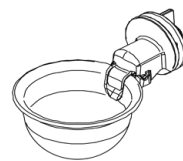

03078100
Sklápěcí napáječka pro drůbež
4 kusy

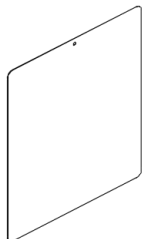

53080802
Gilotinová dvířka ke kurníku
1kus



53080801
Ližina pro gilotinová dvířka
2 kusy

Drobné díly:

Kód	Popis	Počet kusů
	DIN 603 M8x30	32
	DIN 603 M8X60	12
	DIN 933 M8X50	5
	DIN 933 M8x16	4
	DIN 933 M8x30	39
	DIN 933 M8x65	12
	DIN 7985 M5x10	4
	DIN 933 M6x30	10
	DIN 125 M8	120
	DIN 125 M5	14
	DIN 934 M5	6
	DIN 934 M8	80
	DIN 934 M6	10
	DIN 7985 M5x30	10
	DIN 985 M8	6
	DIN 985 M5	8
	DIN 9021 M6	14
	držák (konzole)	20
	pant	4
	nylonové lano l=600 mm	3
	čtvercový blok 30x30	6

1°)

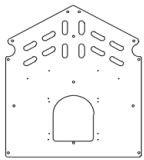

(x1)

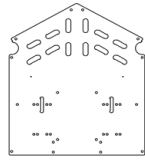

(x1)



D(x2)



I(x2)

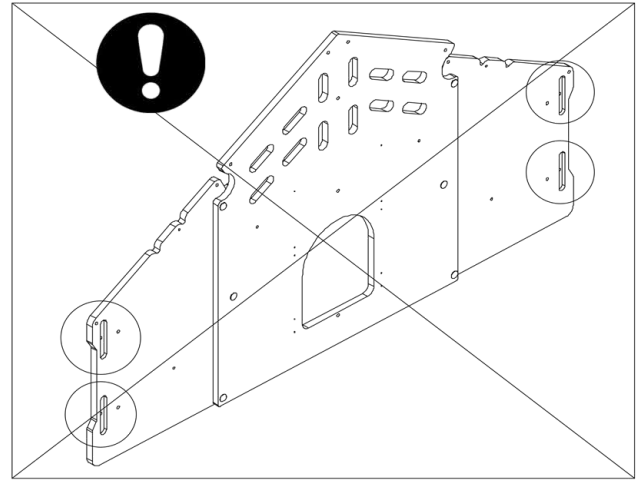

DIN 934 M8 (x12)



DIN 125 M8 (x12)



DIN 603 M8x50 (x12)



A

A

I

D

I

D

2°)



(x8)

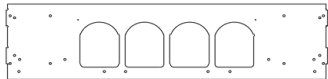

(x1)

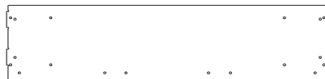

(x1)

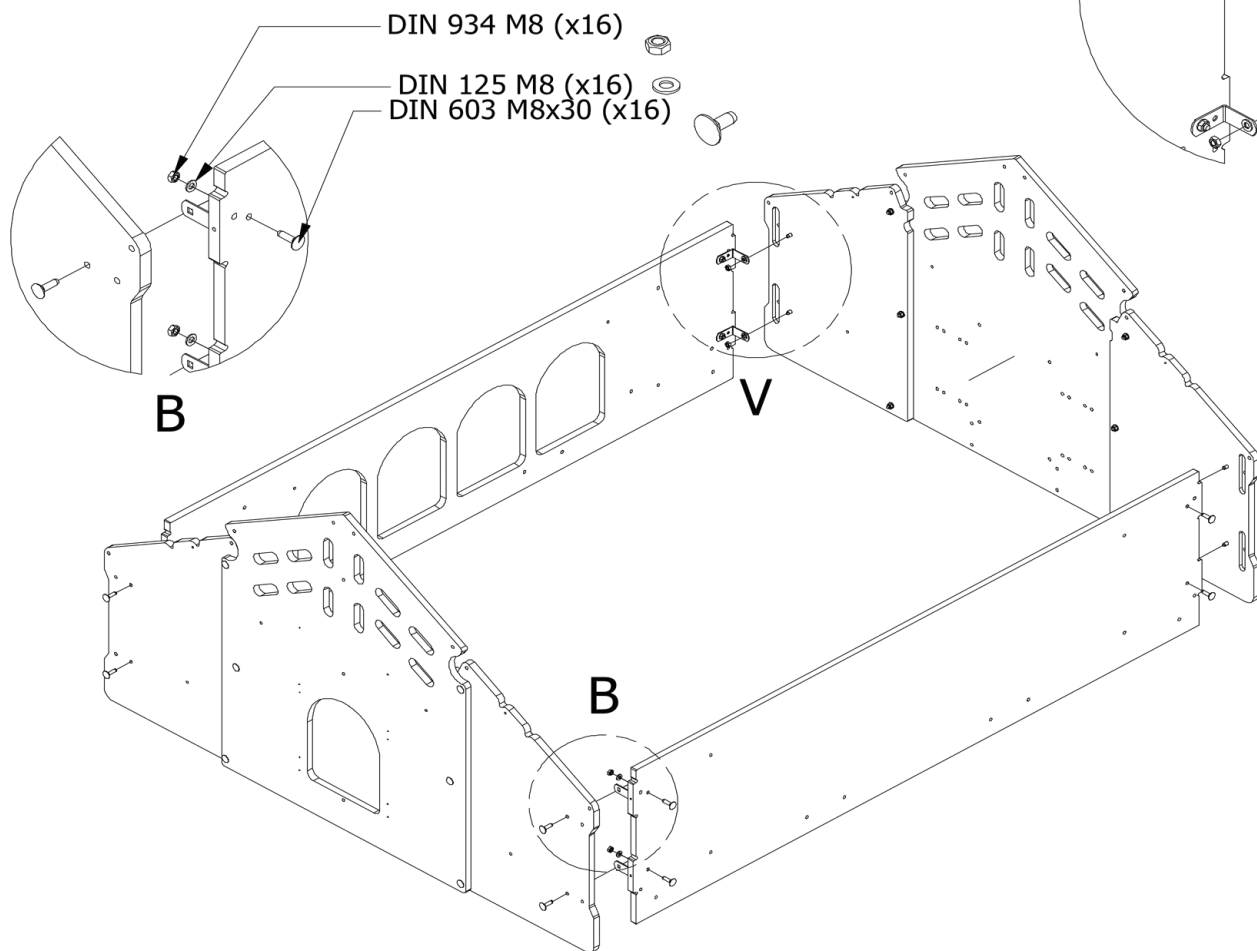

V

B

B

V

3°)

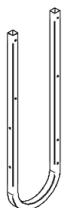

(x3)

C

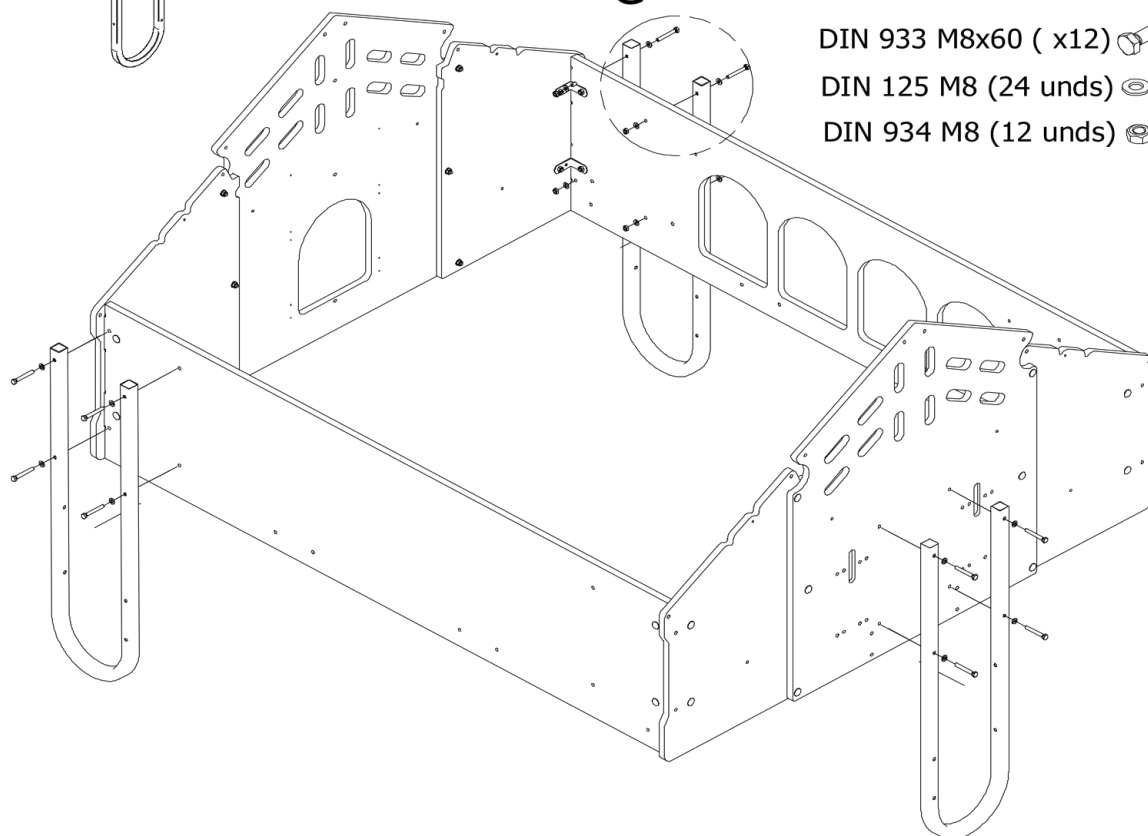

DIN 933 M8x60 (x12)

DIN 125 M8 (24 unds)

DIN 934 M8 (12 unds)

C

4°)

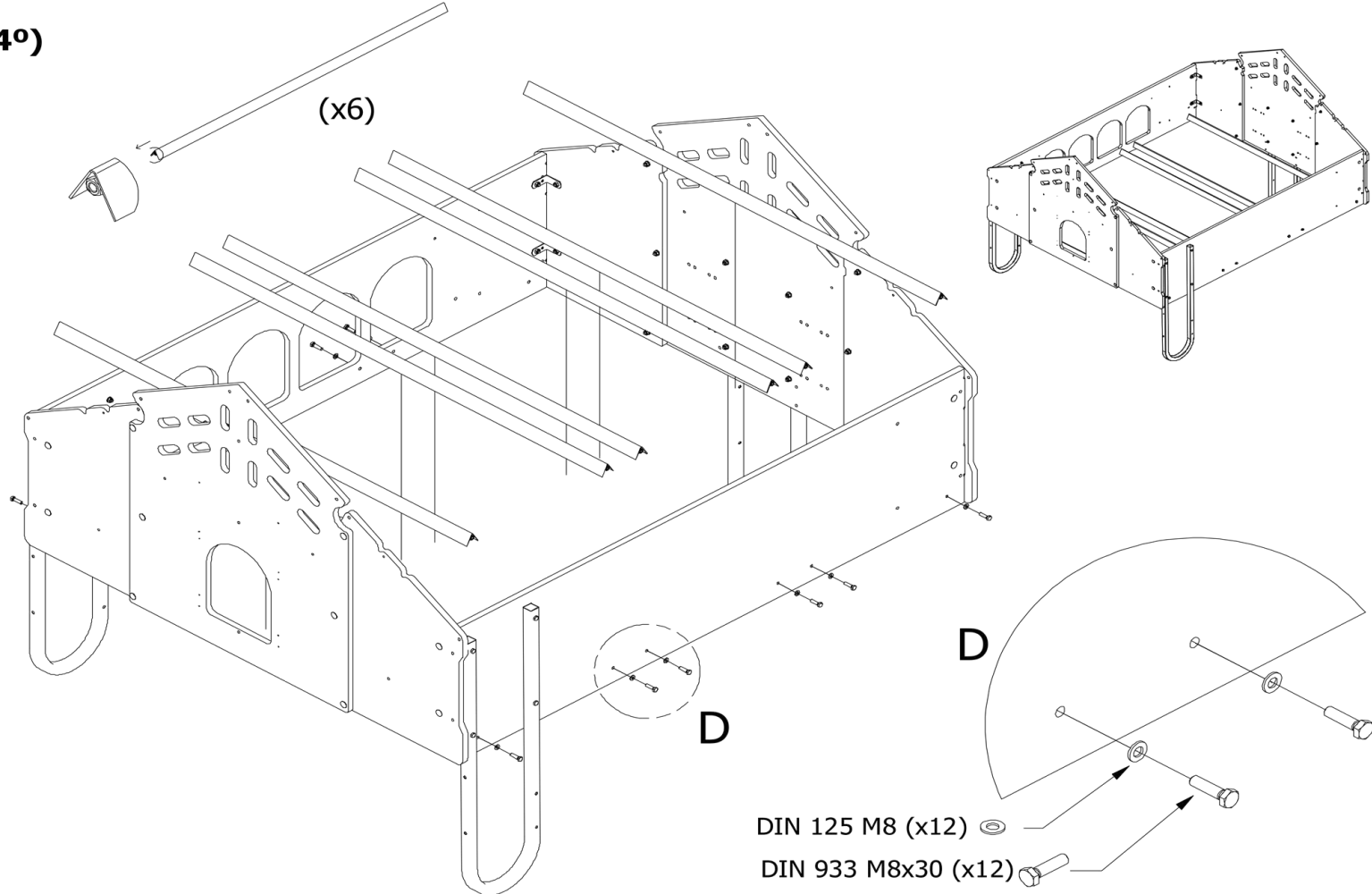

5°)

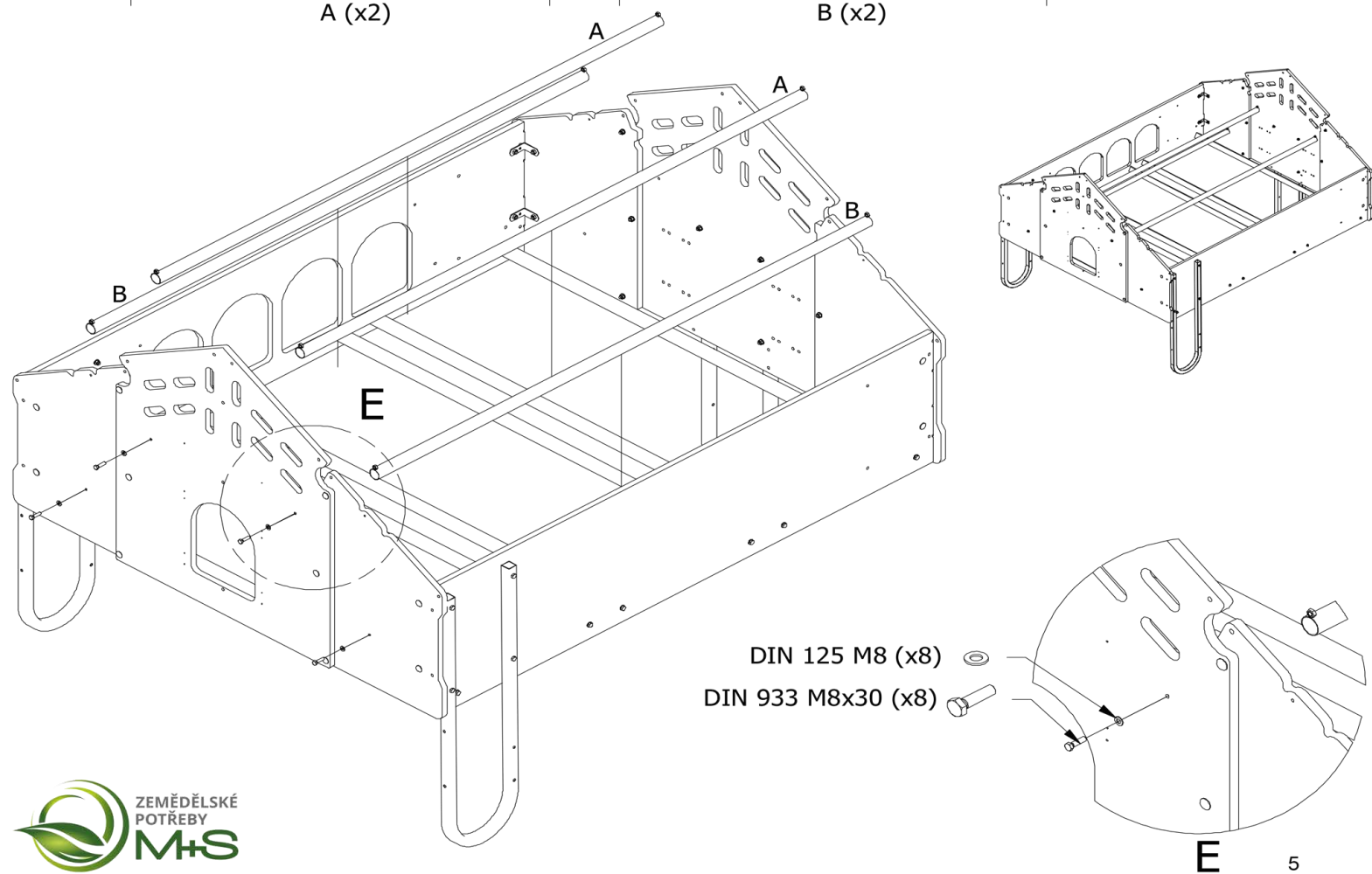
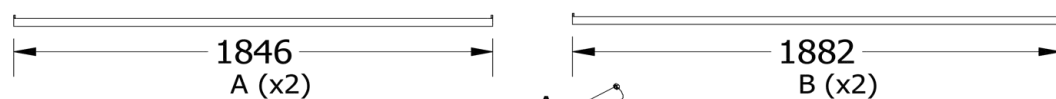

6°)

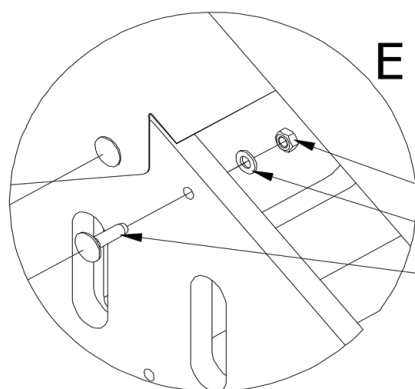
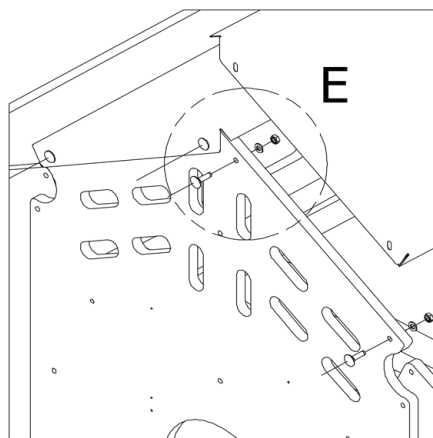
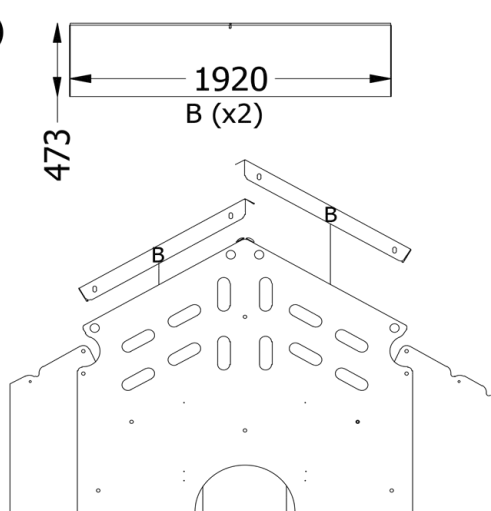

DIN 934 M8 (x8)
DIN 125 M8 (x8)
DIN 603 M8x30 (x8)

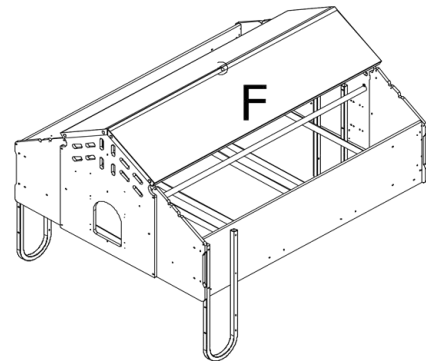

DIN 603 M8x10 (x2)
DIN 125 M8 (x2)
DIN 934 M8 (x2)

7°)

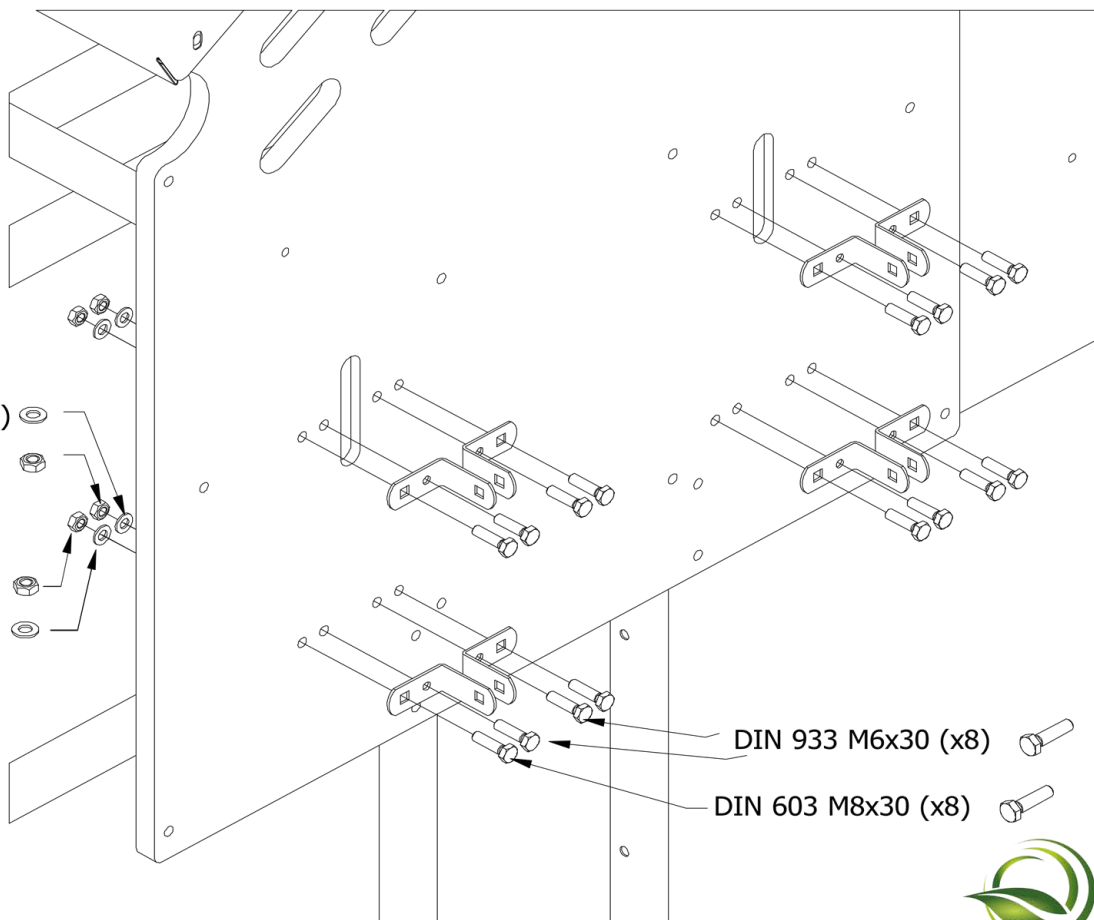
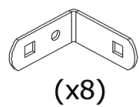

DIN 9021 M6 (x8)
DIN 934 M6 (x8)

DIN 934 M8 (x8)
DIN 9021 M8 (x8)

DIN 933 M6x30 (x8)
DIN 603 M8x30 (x8)

8º)

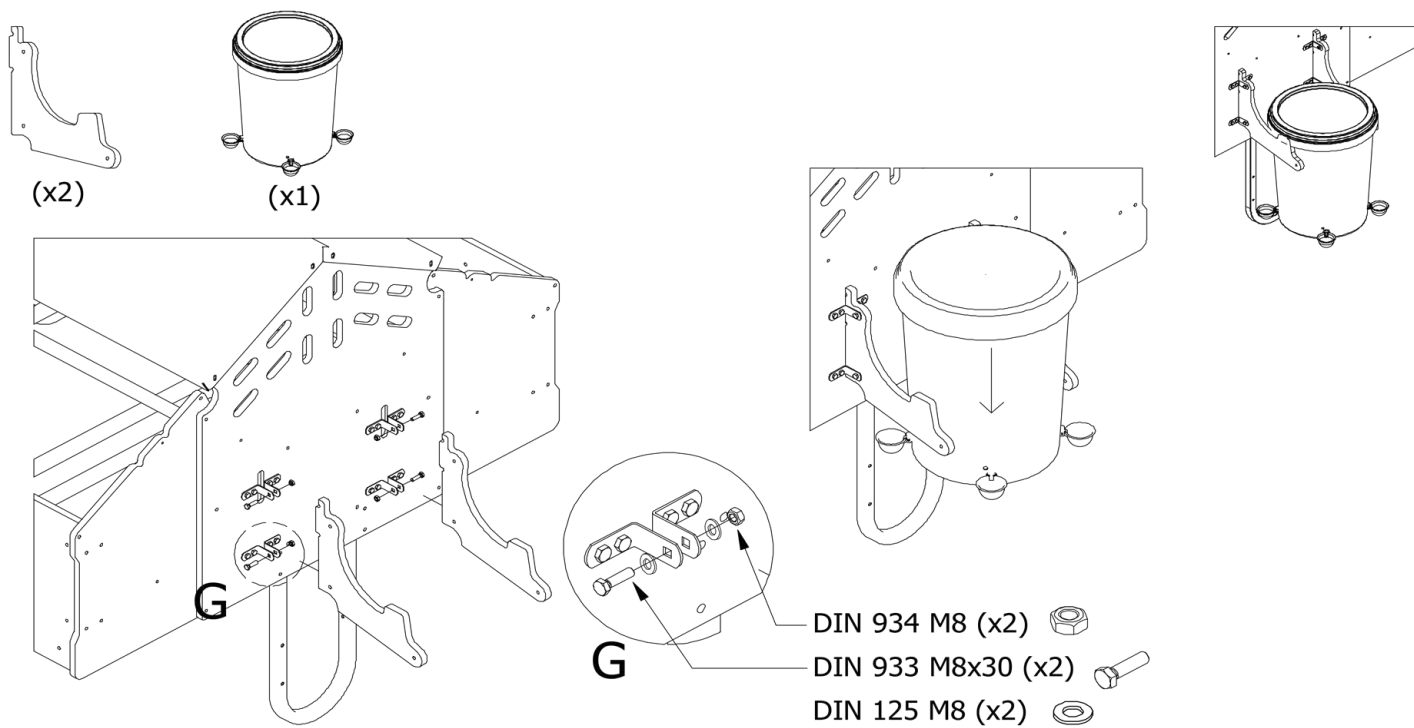

9º)

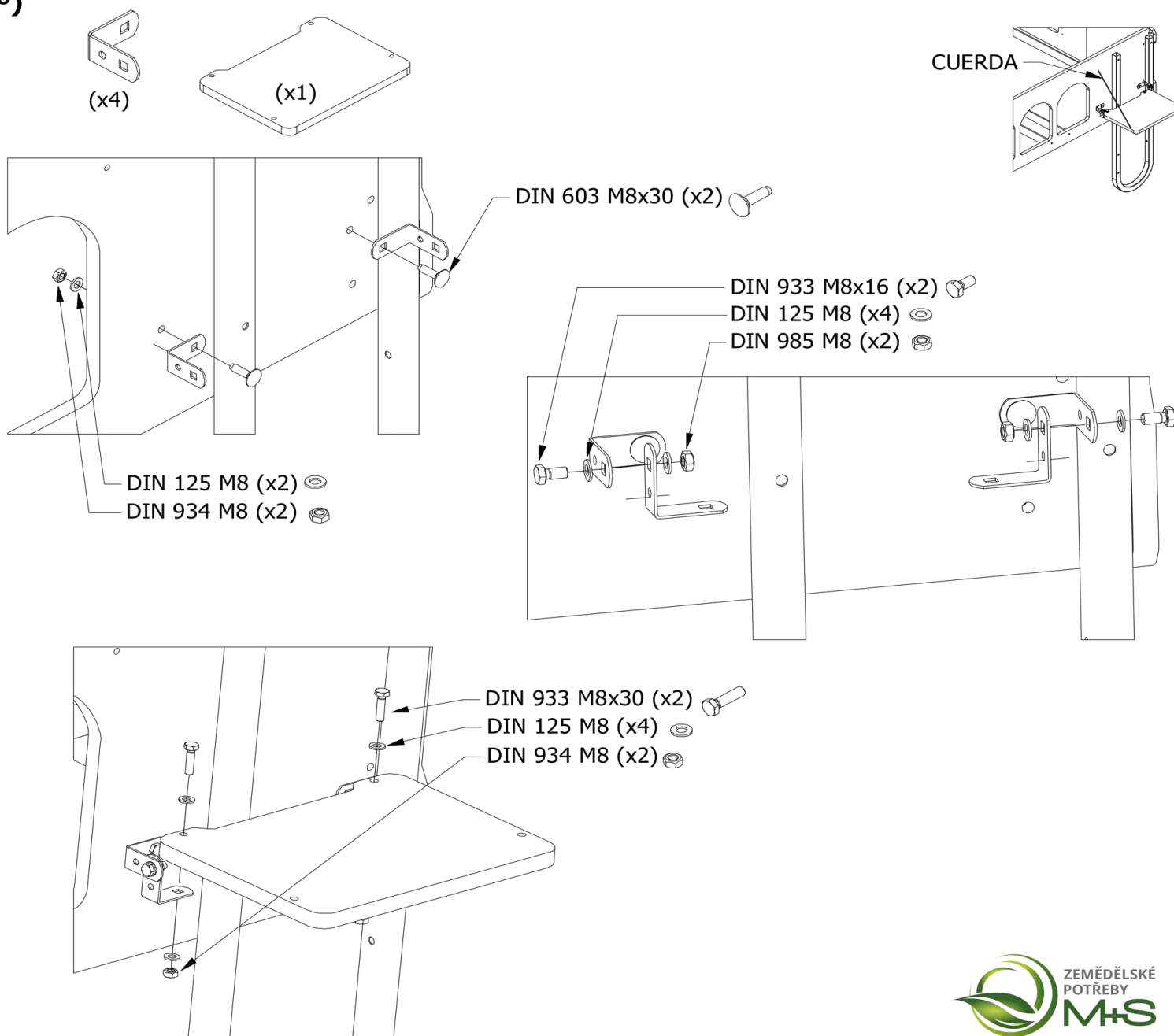

10°)

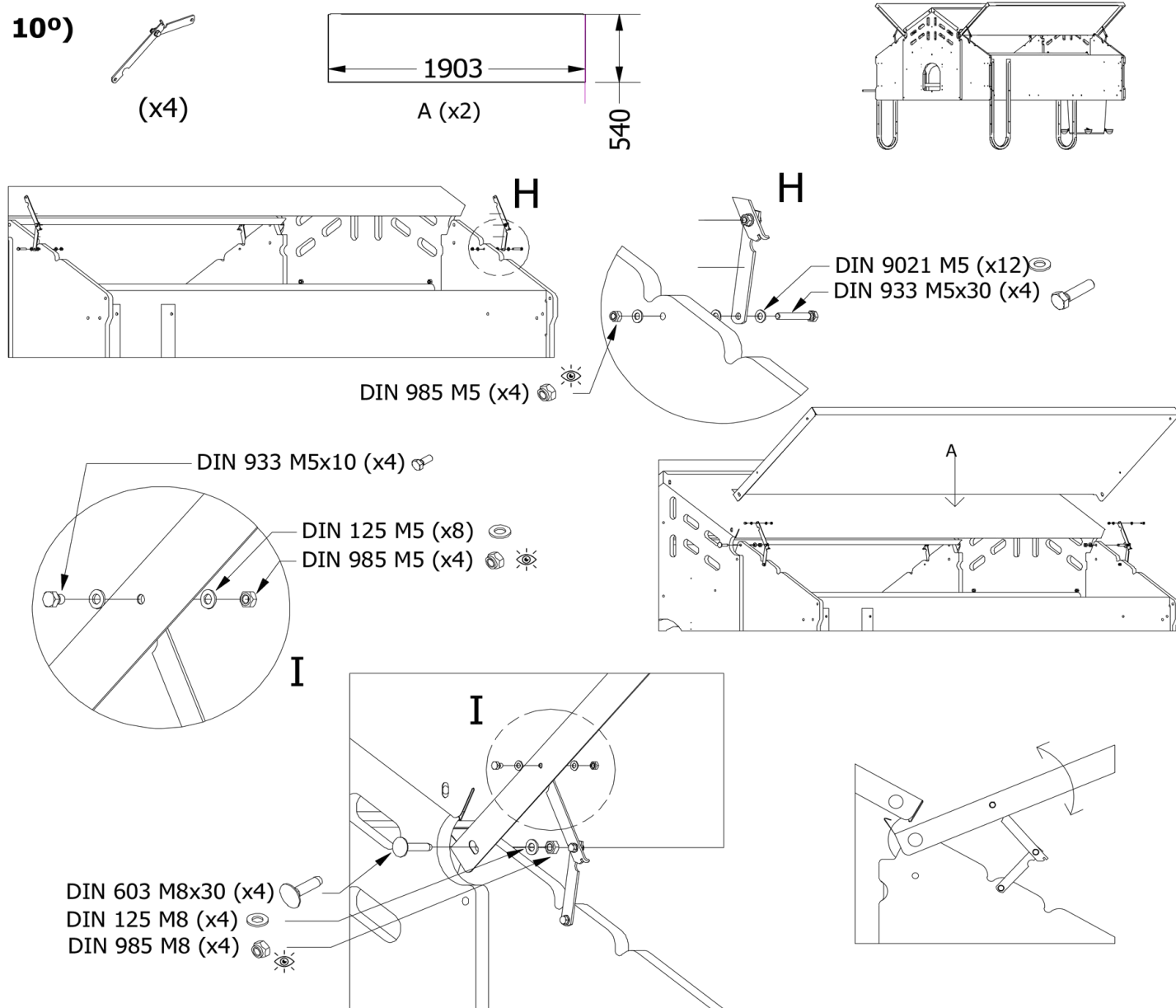

11°)

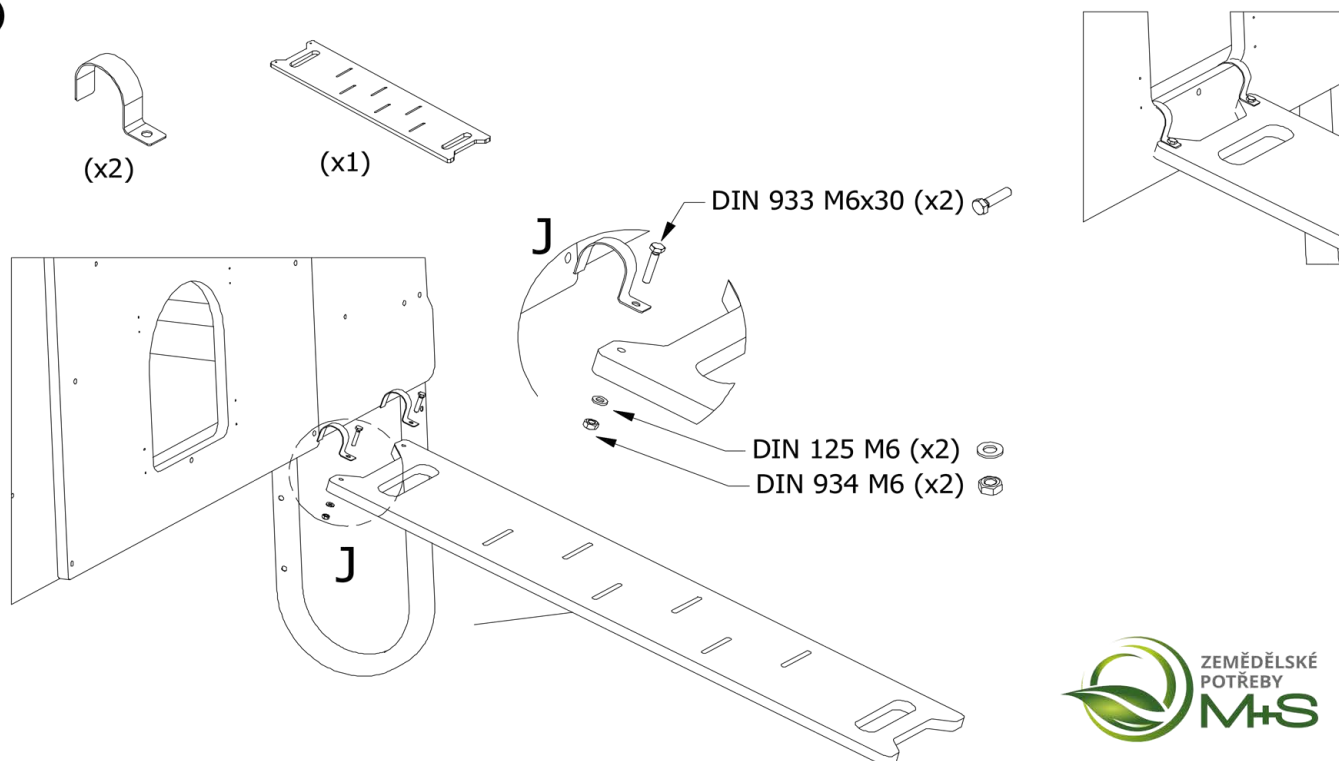

12°)

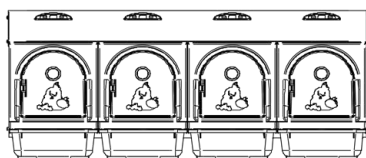

(x1)

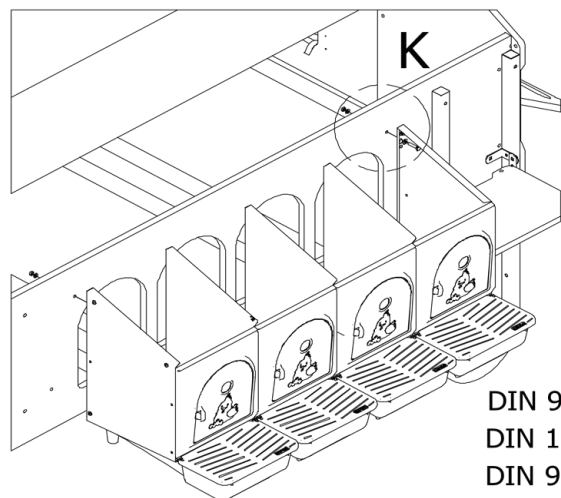
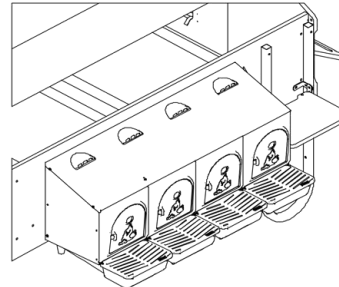

DIN 934 M8 (x2)
DIN 125 M8 (x4)
DIN 933 M8x30 (x2)

K

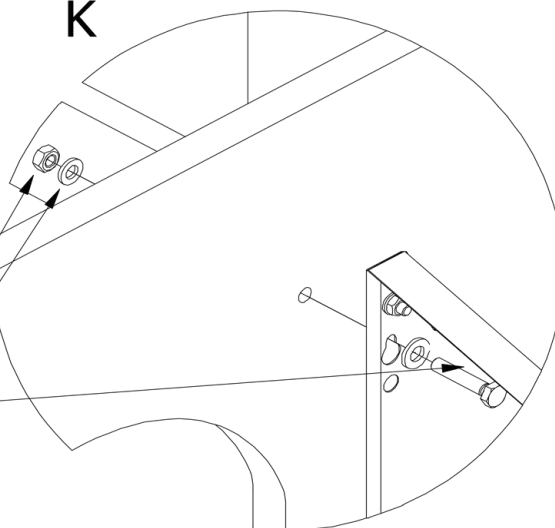

13°)

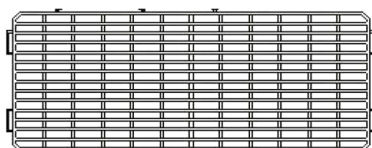

(x15)

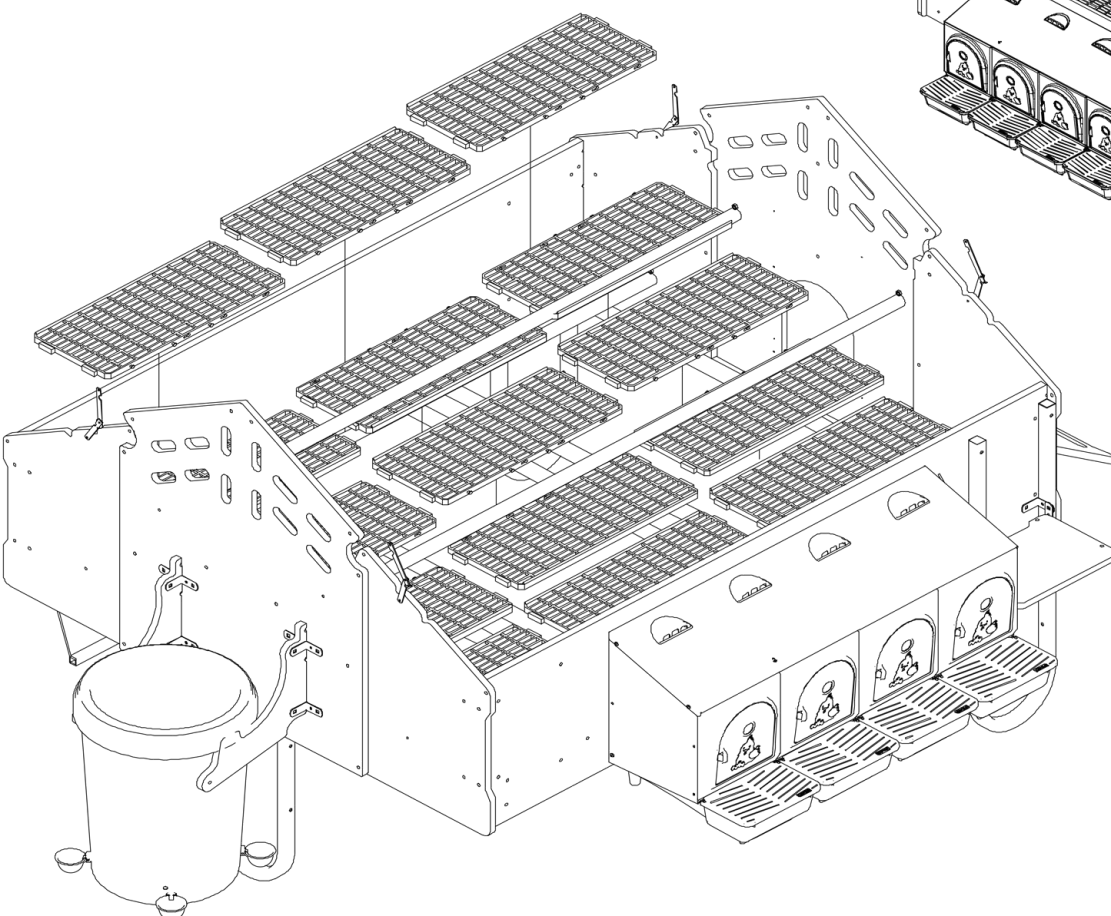
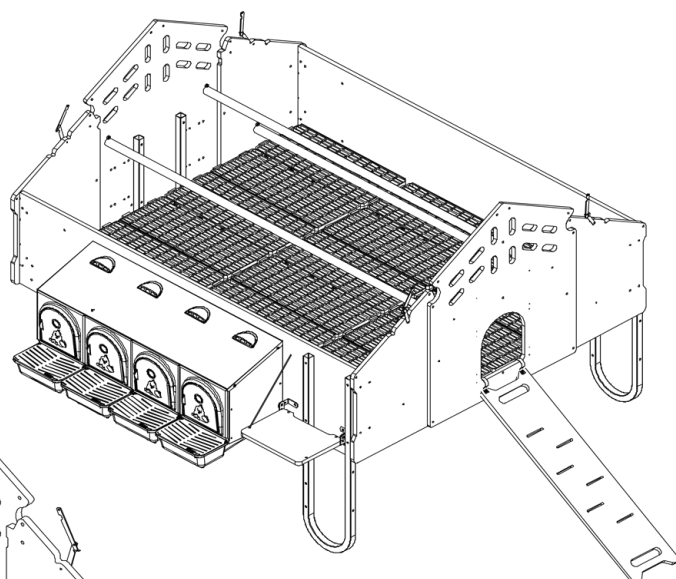

14°)

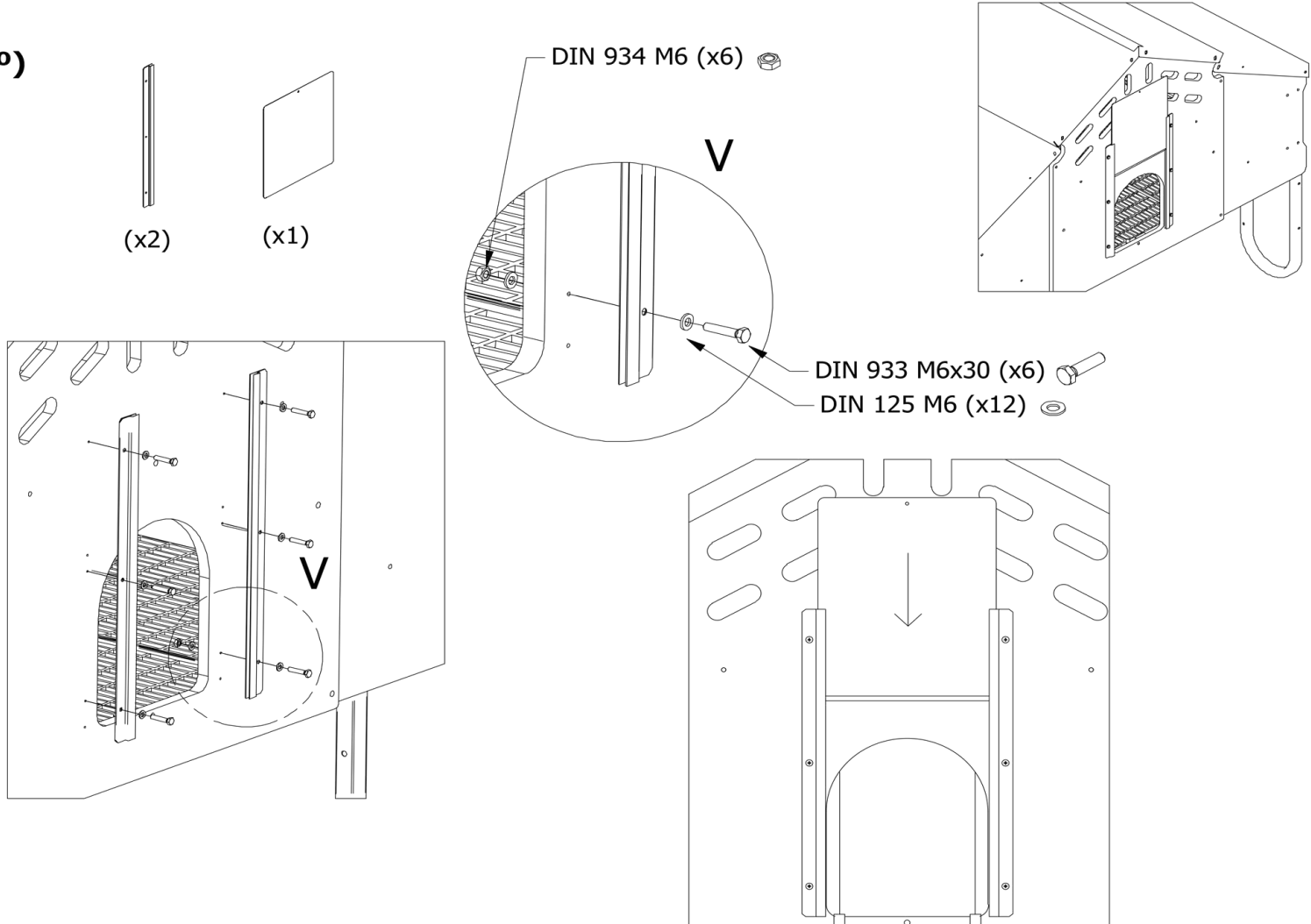

Výsledek:

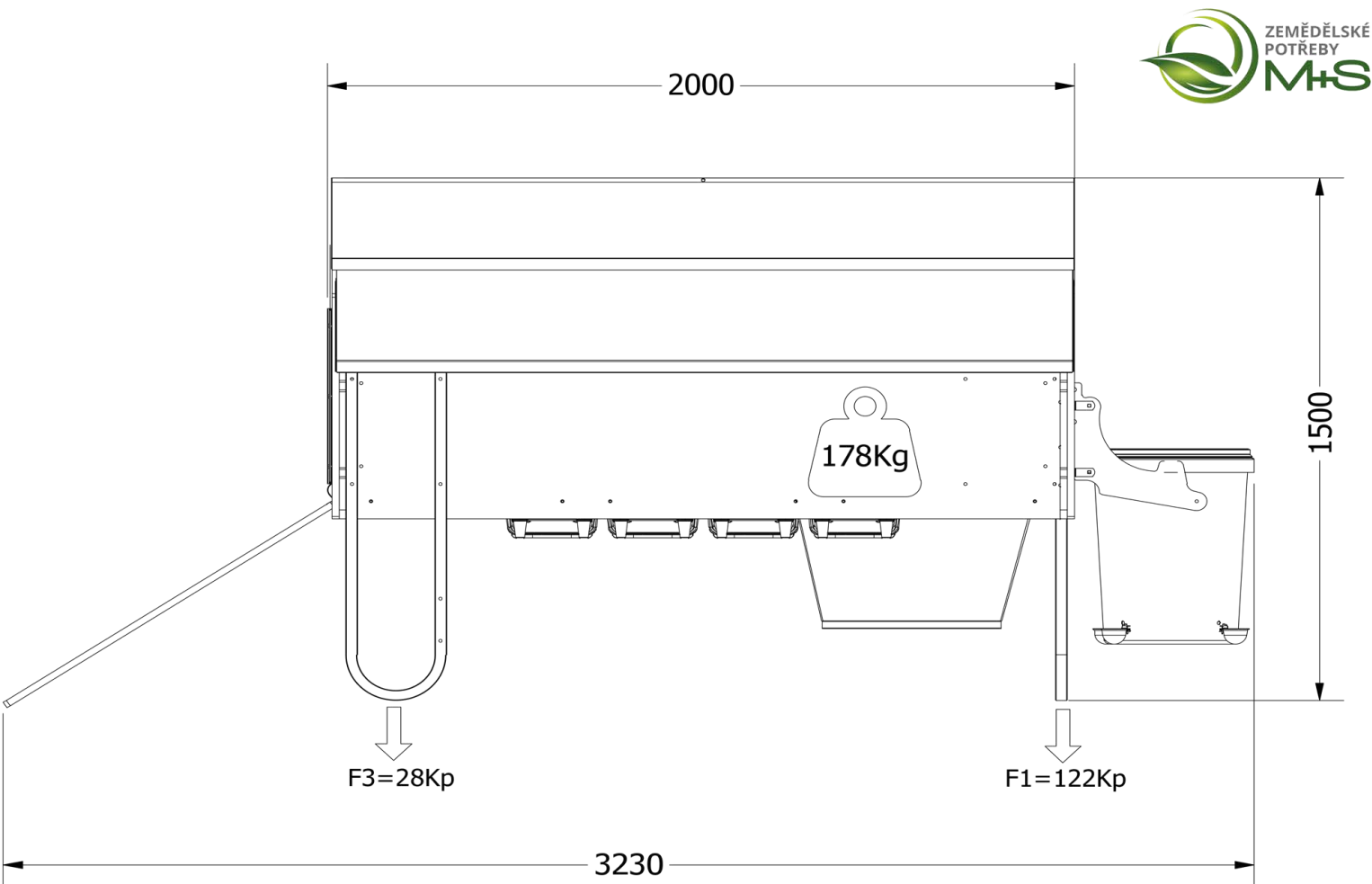

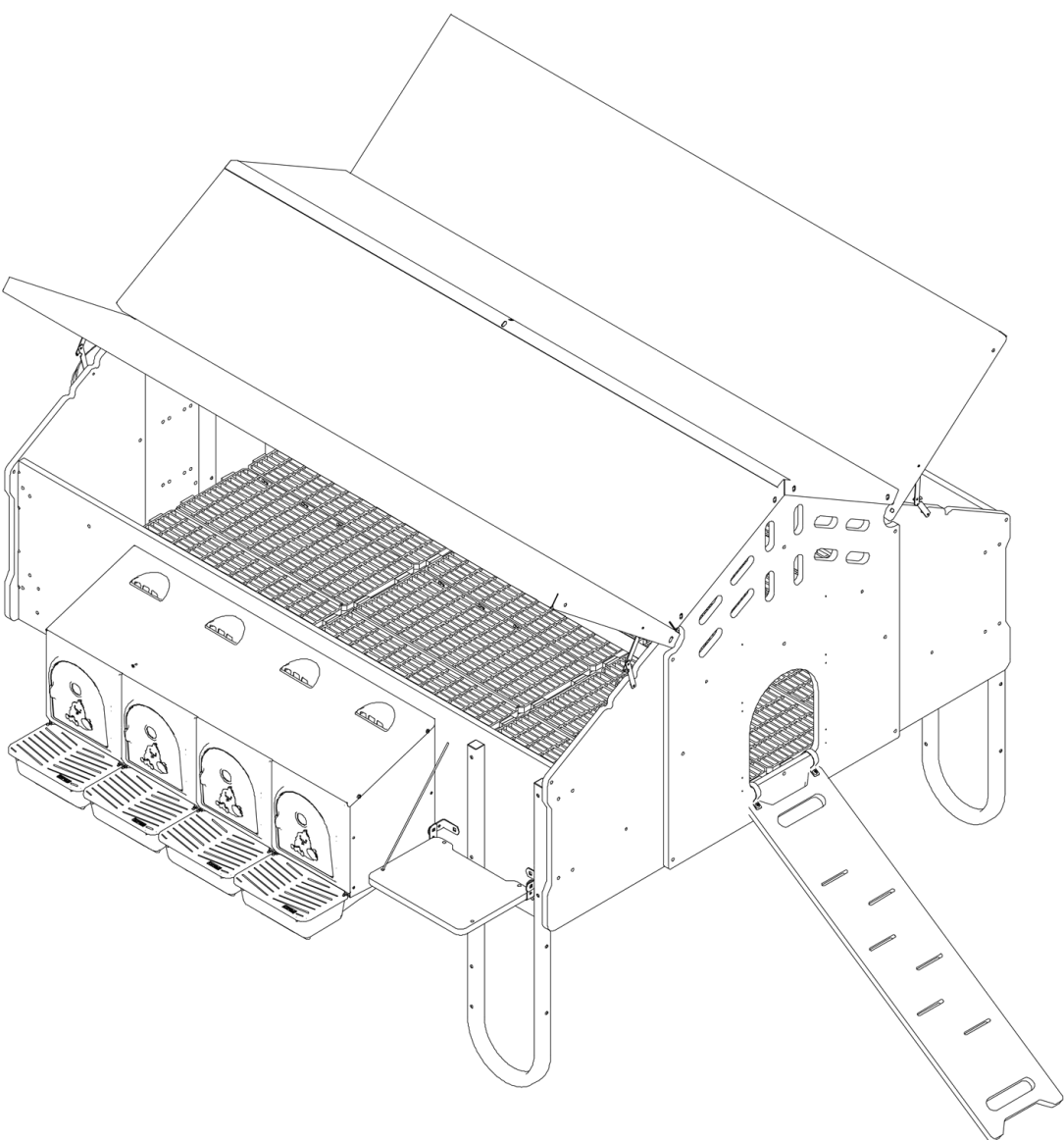
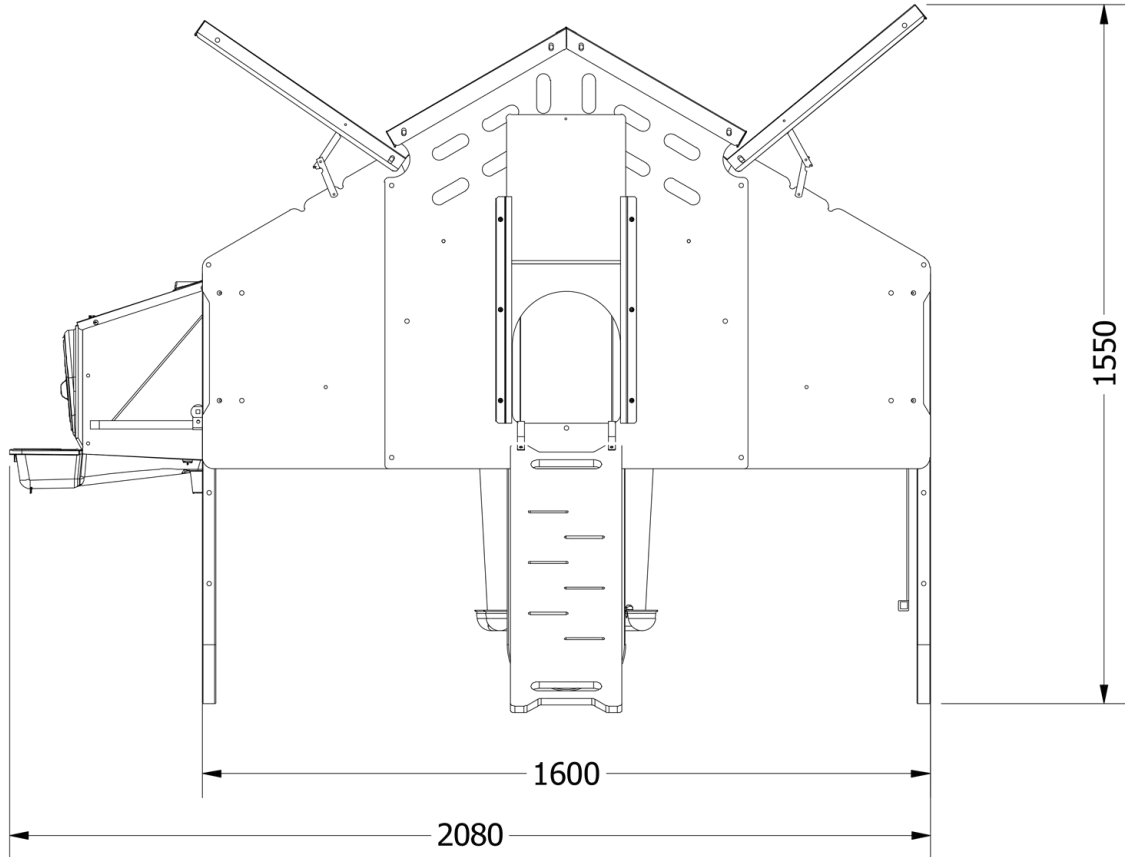

Podvozek

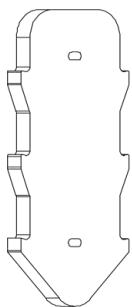

53096803
přední podpěra kola
2 kusy

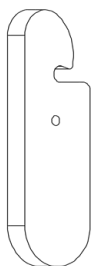

53096801
levé madlo (rukojeť)
2 kusy



53096802
podpěrný klín pro kola
4 kusy

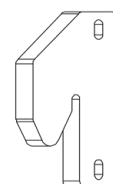

53096804
Boční poděpra kola
4 kusy

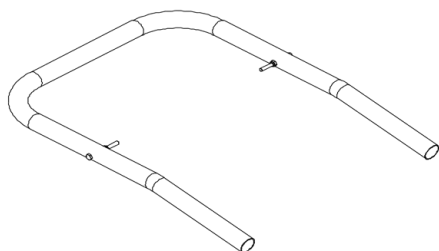

53096805
rukojeť
1 kus

53096810
tyč (táhlo) 12x190
1 kus

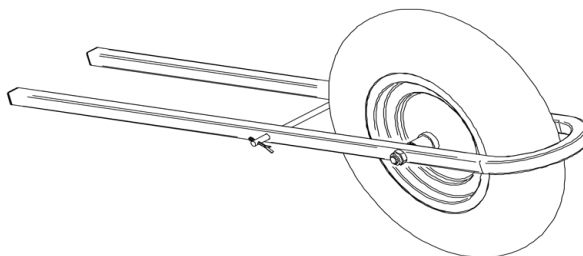

73016301
kolo
2 kusy

53096806
Zaoblený držák
2 kusy

78913700
plastová koncovka
4 kusy

53096809
tyč průměr 8
2 kusy

53096807
osa kola
2 kusy

Drobné díly:

Kód	Popis	Počet kusů
	DIN 603 M8x60	4
	DIN 603 M8x120	4
	DIN 933 M8x50	2
	DIN 933 M6x30	4
	DIN 125 M8	8
	DIN 9021M6	4
	DIN 934 M8	8
	DIN 934 M6	4
	DIN 985 M8	2
	Oblouková svorka D40	2
	kulatá podložka	2
	čtvercová podložka 20x20 cm	4
	DIN 933 M8x60	4
	bezpečnostní hák vidlice sada pro posunutí	2
	DIN 985 M8	2

1°)

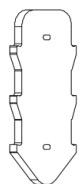

a (x2)

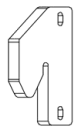

b (x4)



c (x4)

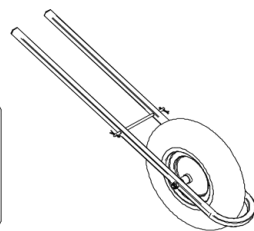

(x2)

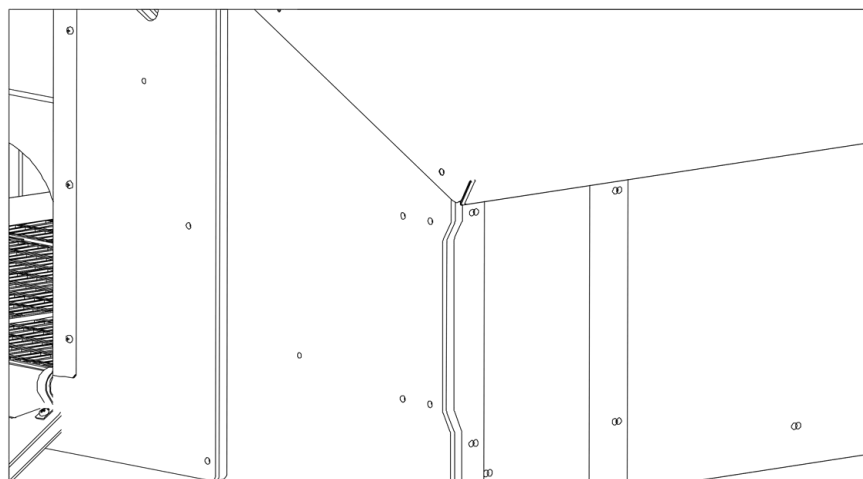
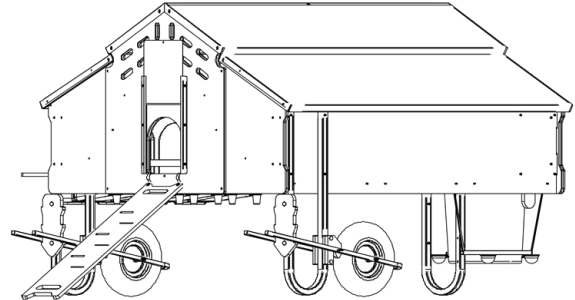

DIN 934 M8 (x8)

DIN 125 M8 (x8)

DIN 603 M8x60 (x4)

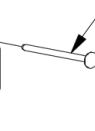
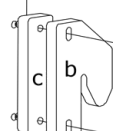
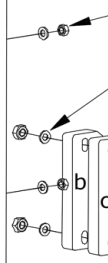
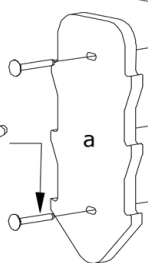

DIN 603 M8x120 (x4)

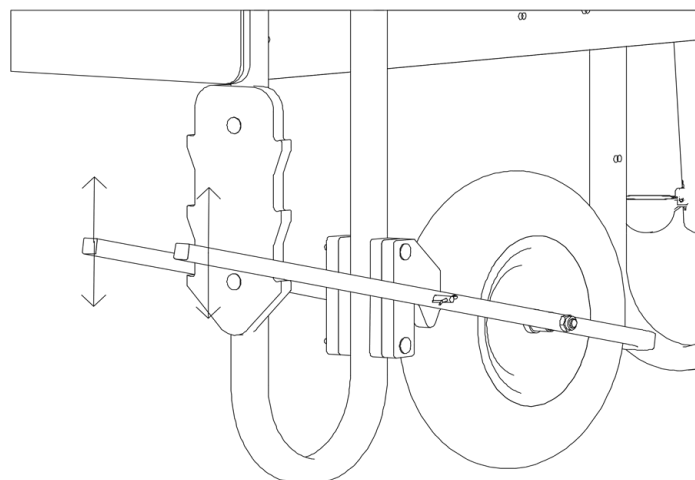
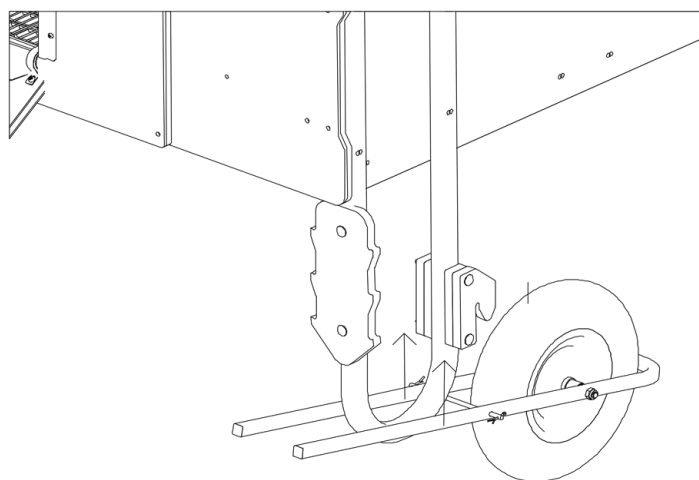
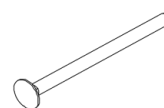

2°)

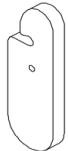

(x2)

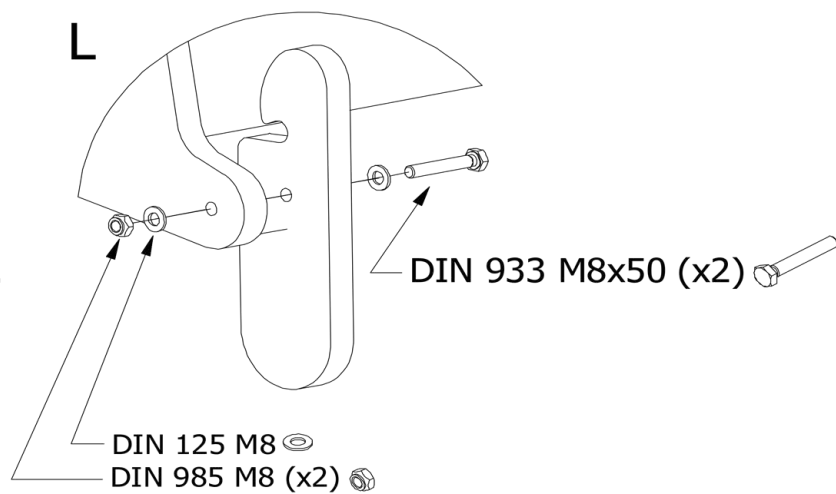
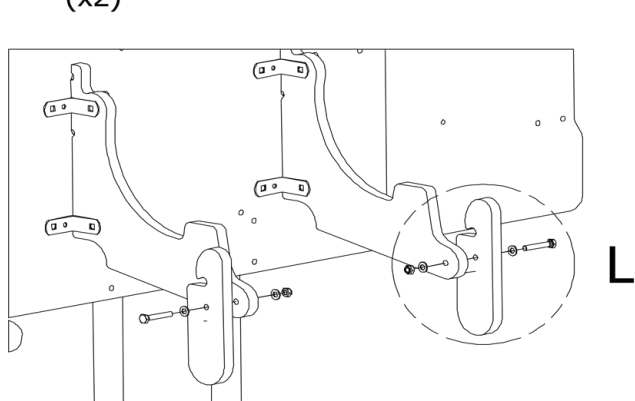

3°)

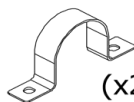

(x2)

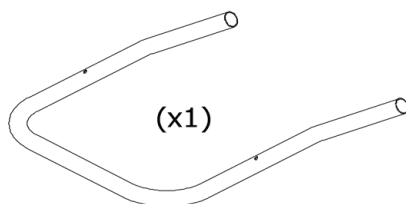

(x1)

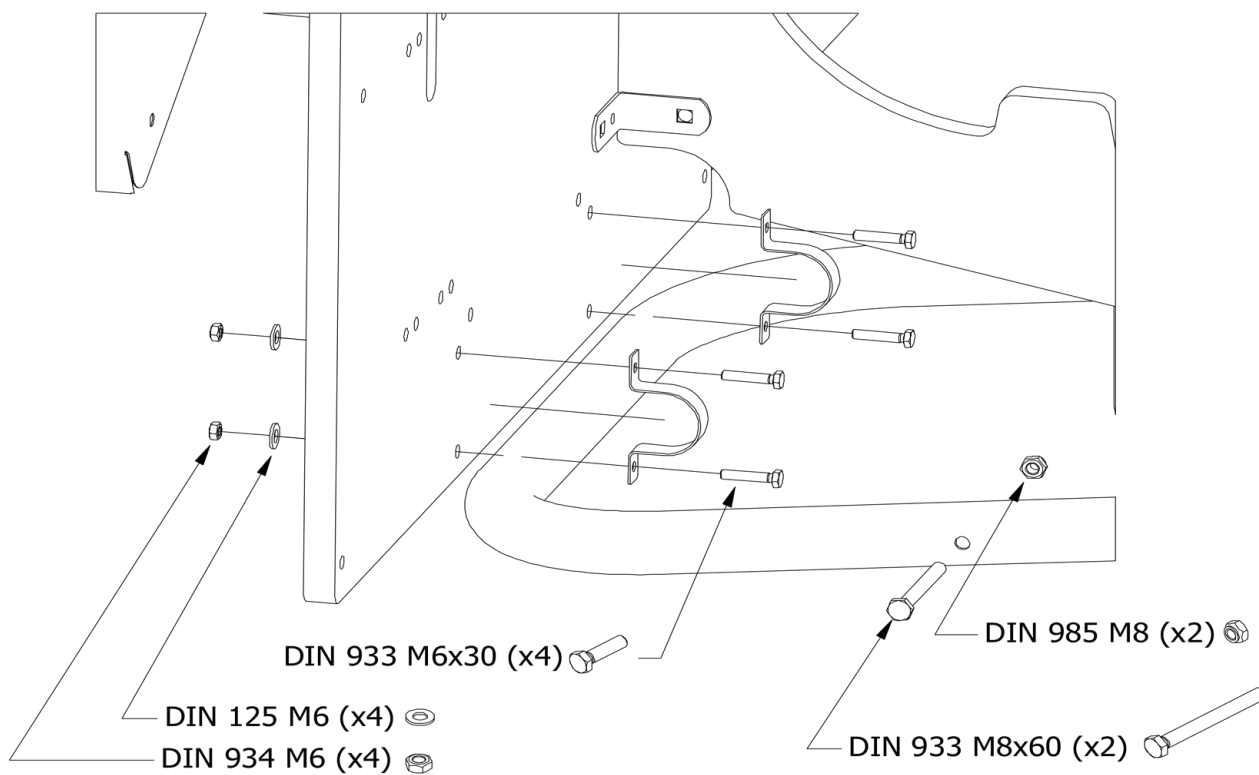

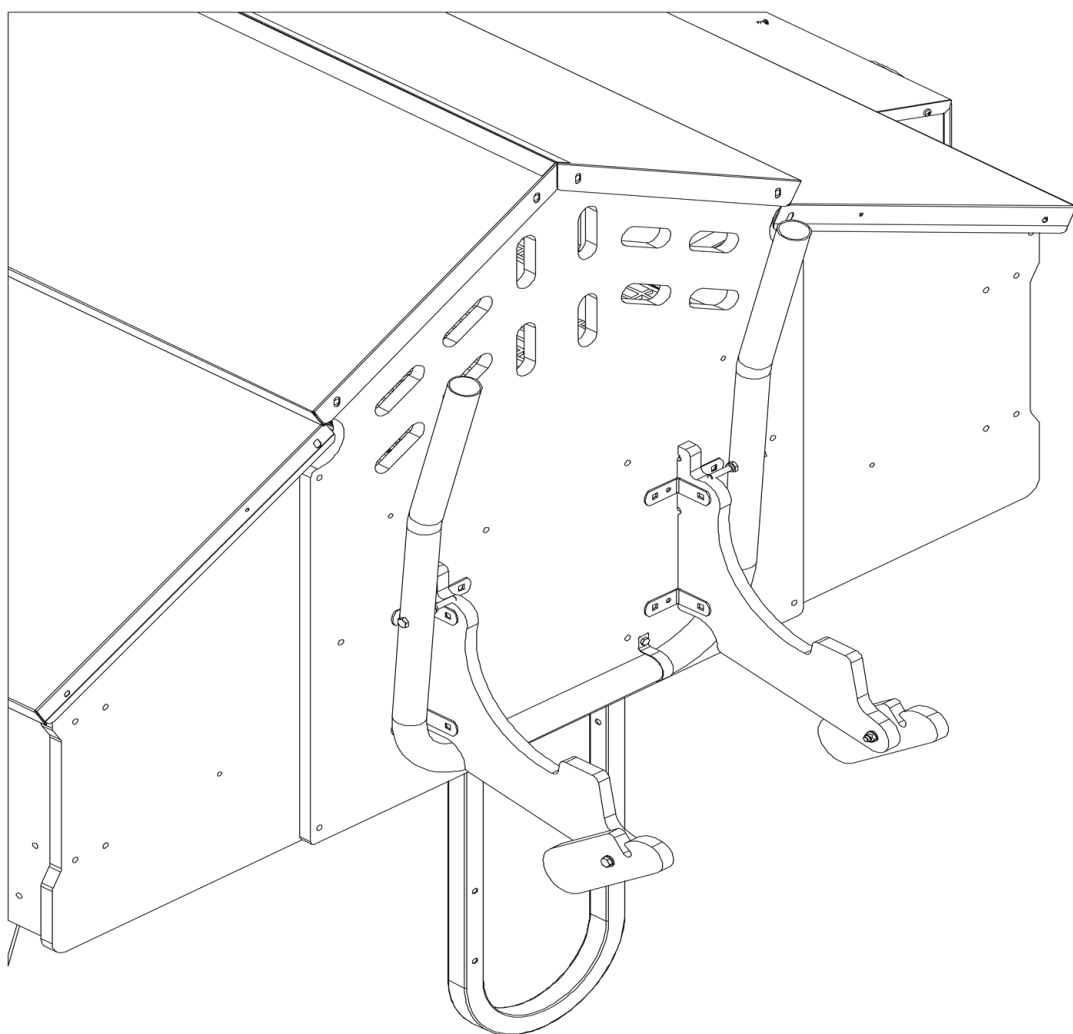
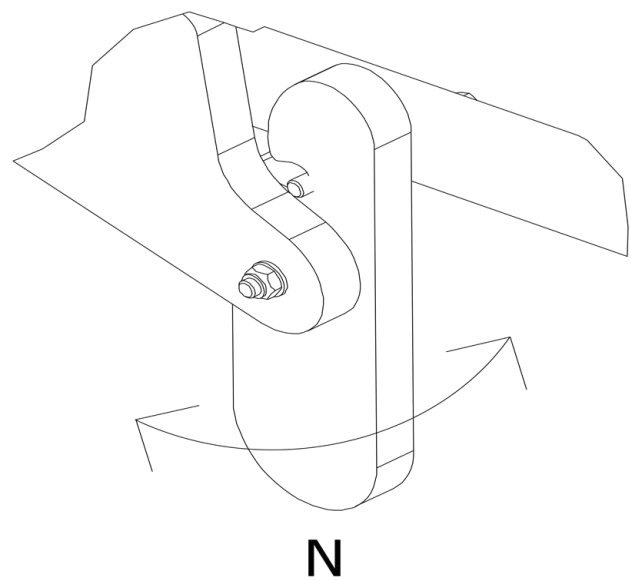
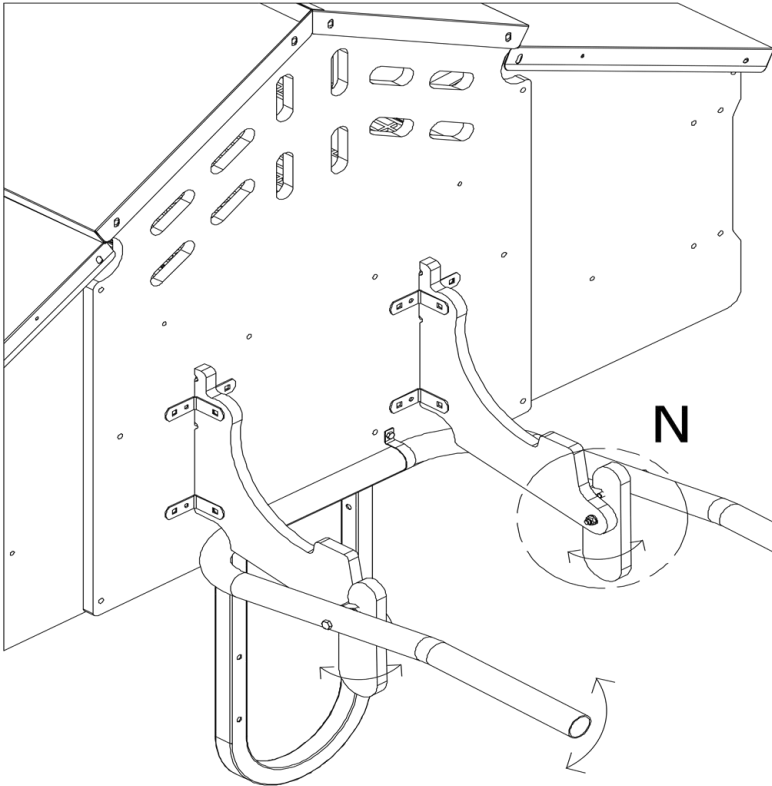

Výsledek:

